

- NOTES:**
1. THE LEGAL RIGHT-OF-WAY ON KENMAWR AVENUE FROM STA 60+82.00 TO STA 62+87.79 IS VARIABLE BASED ON THE PLAN AND PROFILE OF STREETS IN HAWKINS VILLAGE APPROVED BY THE COUNCIL OF RANKIN BOROUGH BY RESOLUTION ON APRIL 18, 1958, RECORDED ON SEPTEMBER 18, 1958 IN THE OFFICE FOR THE DEPARTMENT OF REAL ESTATE IN ALLEGHENY COUNTY IN PLAN BOOK VOLUME 65, PAGES 142-146.
 2. THE LEGAL RIGHT-OF-WAY ON KENMAWR AVENUE FROM STA 62+87.79 TO STA 63+96.24 IS 44 FEET, FROM STA 63+96.24 TO STA 65+67.57 IS 22 FEET ON THE RIGHT AND FROM STA 63+96.24 TO STA 64+44.24 IS VARIABLE ON THE LEFT BASED ON THE RIVERVIEW PLAN OF LOTS-C APPROVED BY THE COUNCIL OF RANKIN BOROUGH ON DECEMBER 21, 1898, RECORDED ON DECEMBER 22, 1898 IN THE OFFICE FOR THE DEPARTMENT OF REAL ESTATE IN ALLEGHENY COUNTY IN PLAN BOOK VOLUME 17, PAGE 26.
 3. THE LEGAL RIGHT-OF-WAY ON KENMAWR AVENUE FROM STA 64+44.24 TO STA 65+76.24 IS VARIABLE ON THE LEFT BASED ON BOROUGH OF RANKIN ORDINANCE NO. 145 ADOPTED AND APPROVED FEBRUARY 13, 1964, FILED IN THE RANKIN BOROUGH MUNICIPAL BUILDING IN VOLUME 3, PAGE 324.
 4. DRAWINGS AUTHORIZING ACQUISITION OF RIGHT-OF-WAY FOR REPLACEMENT OF KENMAWR BRIDGE WERE RECORDED IN ALLEGHENY COUNTY DEPARTMENT OF REAL ESTATE IN PLANS - MISCELLANEOUS BOOK 173, PAGE 56 ON NOVEMBER 22, 2017. THE DRAWINGS WERE REVISED AND RECORDED IN PLANS - MISCELLANEOUS BOOK 177, PAGE 34 ON NOVEMBER 7, 2018.

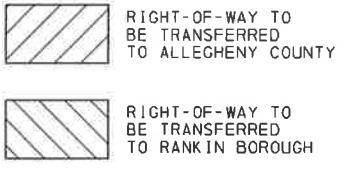

County of Allegheny

Pittsburgh, Pennsylvania
Department of Public Works

ROAD TRANSFER PLAN
REPLACEMENT OF KENMAWR BRIDGE

RANKIN BOROUGH
NS01-0301

EXHIBIT A

SCALE





LIMIT OF COUNTY
MAINTENANCE
RESPONSIBILITY
(STA 67+30.00)

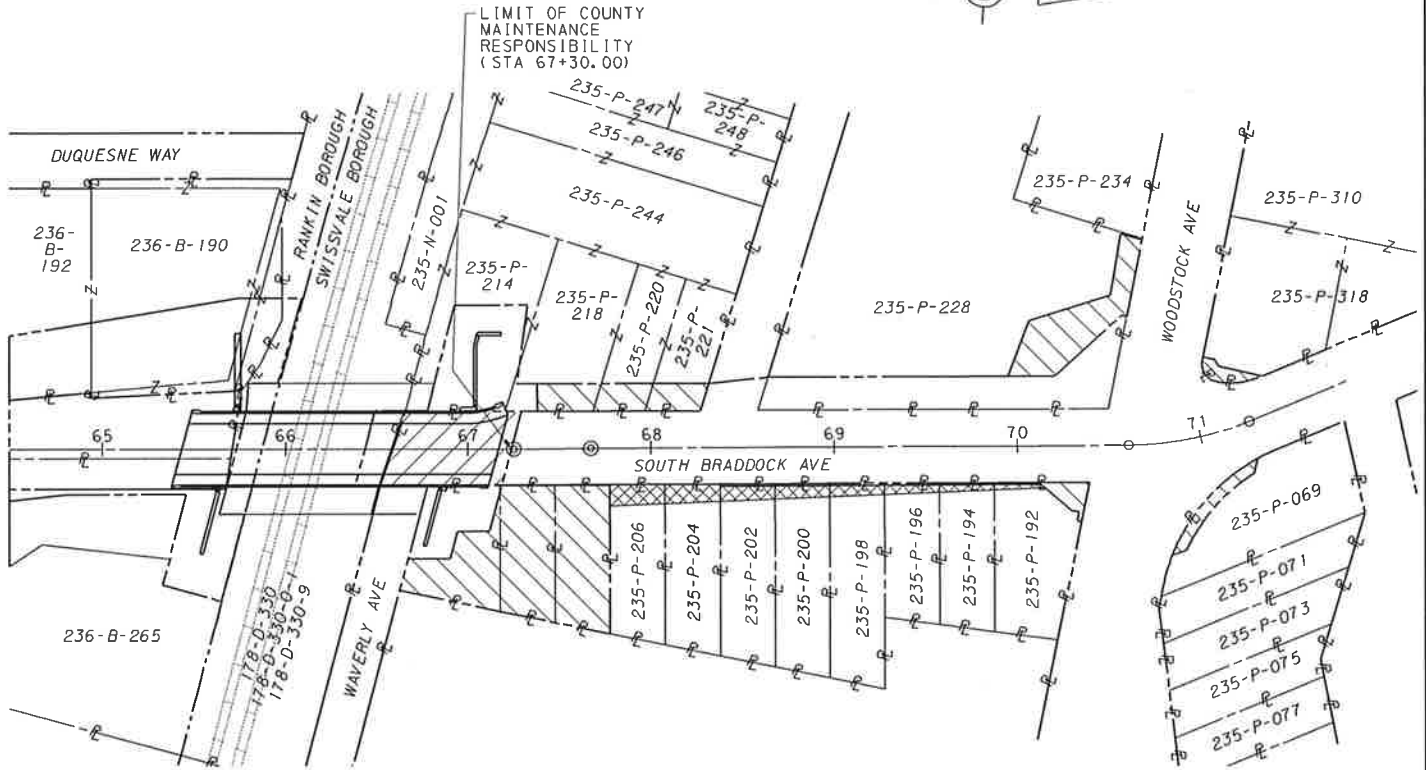

NOTES:

1. THE LEGAL RIGHT-OF-WAY ON SOUTH BRADDOCK AVENUE FROM STA 66+55.89 TO STA 68+63.79 AND FROM STA 70+60.01 TO STA 71+51.02 IS 40 FEET AND FROM STA 68+63.79 TO STA 70+60.01 IS 20 FEET ON THE RIGHT BASED ON BOROUGH OF SWISSVALE ORDINANCE NO. 369 ADOPTED AND APPROVED FEBRUARY 20, 1908, FILED IN THE SWISSVALE BOROUGH MUNICIPAL BUILDING.
2. THE LEGAL RIGHT-OF-WAY ON SOUTH BRADDOCK AVENUE FROM STA 68+63.79 TO STA 70+60.01 IS VARIABLE ON THE LEFT BASED ON THE BOROUGH OF SWISSVALE ORDINANCE NO. 17-06 ADOPTED AND APPROVED SEPTEMBER 6, 2017, FILED IN THE SWISSVALE BOROUGH MUNICIPAL BUILDING.
3. DRAWINGS AUTHORIZING ACQUISITION OF RIGHT-OF-WAY FOR REPLACEMENT OF KENMAWR BRIDGE WERE RECORDED IN ALLEGHENY COUNTY DEPARTMENT OF REAL ESTATE IN PLANS - MISCELLANEOUS BOOK 173, PAGE 56 ON NOVEMBER 22, 2017. THE DRAWINGS WERE REVISED AND RECORDED IN PLANS - MISCELLANEOUS BOOK 177, PAGE 34 ON NOVEMBER 7, 2018.



RIGHT-OF-WAY TO
BE TRANSFERRED TO
ALLEGHENY COUNTY



RIGHT-OF-WAY TO
BE TRANSFERRED TO
SWISSVALE BOROUGH

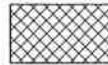

SLOPE EASEMENT TO
BE TRANSFERRED TO
SWISSVALE BOROUGH

County of Allegheny

Pittsburgh, Pennsylvania
Department of Public Works

ROAD TRANSFER PLAN
REPLACEMENT OF KENMAWR BRIDGE
SWISSVALE BOROUGH
NS01-0301

EXHIBIT B

SCALE

0 50 100 FEET