

PARCEL NUMBERS	PROPERTY OWNERS
①	JOSEPH J. CHIDO AND FLORENCE P. CHIDO, HIS WIFE
②	DANIEL F. FORADAS, CAROLINA C. COUVARIS & PELAGIA TRUSKY, A PARTNERSHIP
③	JOSEPH DI IORIO AND FRANCES DI IORIO, HIS WIFE
④	GENERAL CLEANING, INC., A PENNSYLVANIA CORPORATION
⑤	PENNSYLVANIA LINES, LLC
⑥	THE WATERFRONT PARTNERS, LLC
⑦	CSX TRANSPORTATION, INC.
⑧	INLAND SOUTHEAST WATERFRONT TOWN CENTER DS
⑨	MAY DEPARTMENT STORES COMPANY
⑩	INLAND SOUTHEAST WATERFRONT DST
⑪	Z. SCOTT SMITH
⑫	THE WATERFRONT PARTNERS, LLC
⑬	INLAND SOUTHEAST WATERFRONT DST
⑭	INLAND SOUTHEAST WATERFRONT MARKET DST
⑮	THE WATERFRONT PARTNERS, LLC
⑯	CSX TRANSPORTATION, INC.
⑰	HOUSING AUTHORITY OF THE CITY OF PITTSBURGH
⑱	JEWISH HOME AND HOSPITAL FOR AGED AT PITTSBURGH
⑲	EDWARD BARRETT AND VIRGINIA BARRETT, MARRIED

SHEET INDEX	
DESCRIPTION	SHEET
TITLE SHEET	1
INDEX MAP	2
GENERAL NOTES	3
SUMMARY OF PROJECT COORDINATES	3
DETAIL PLAN SHEETS	4-9
TABULATION OF PROPERTIES	10

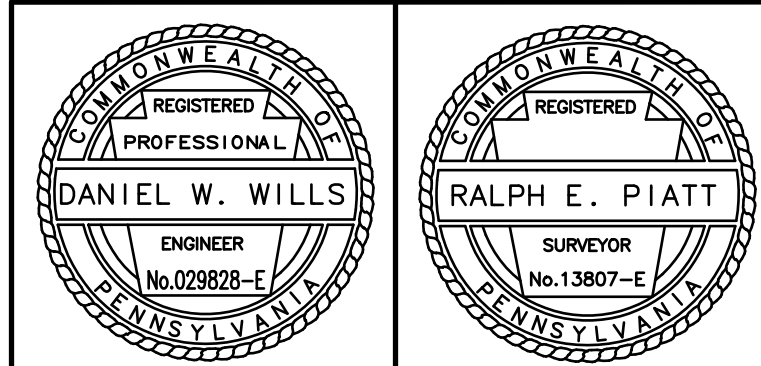
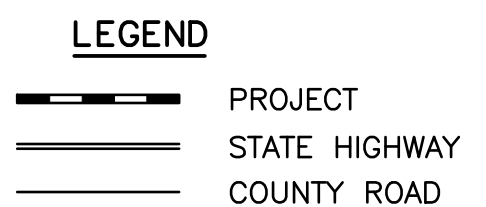
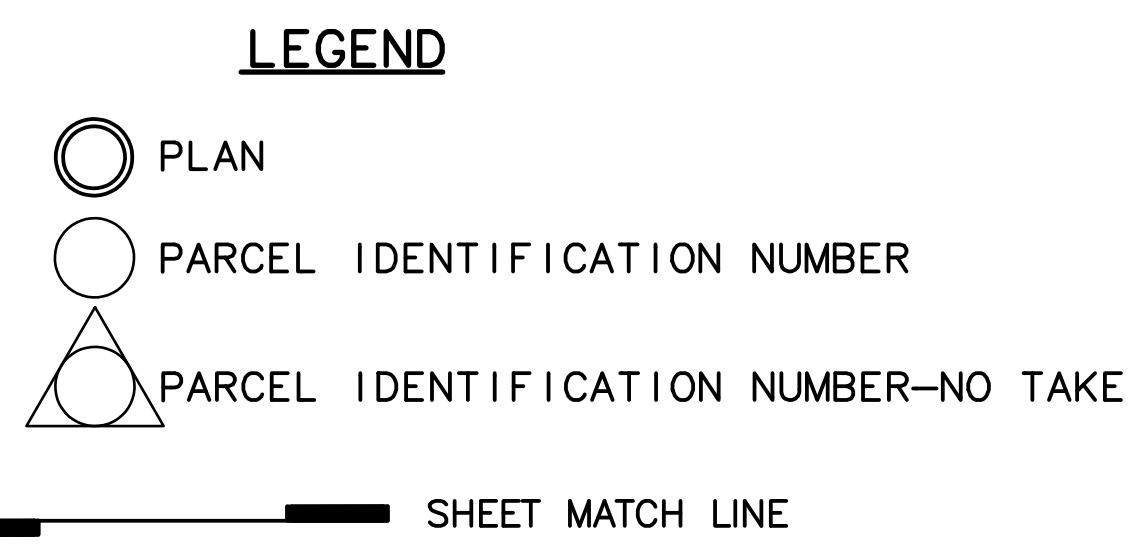
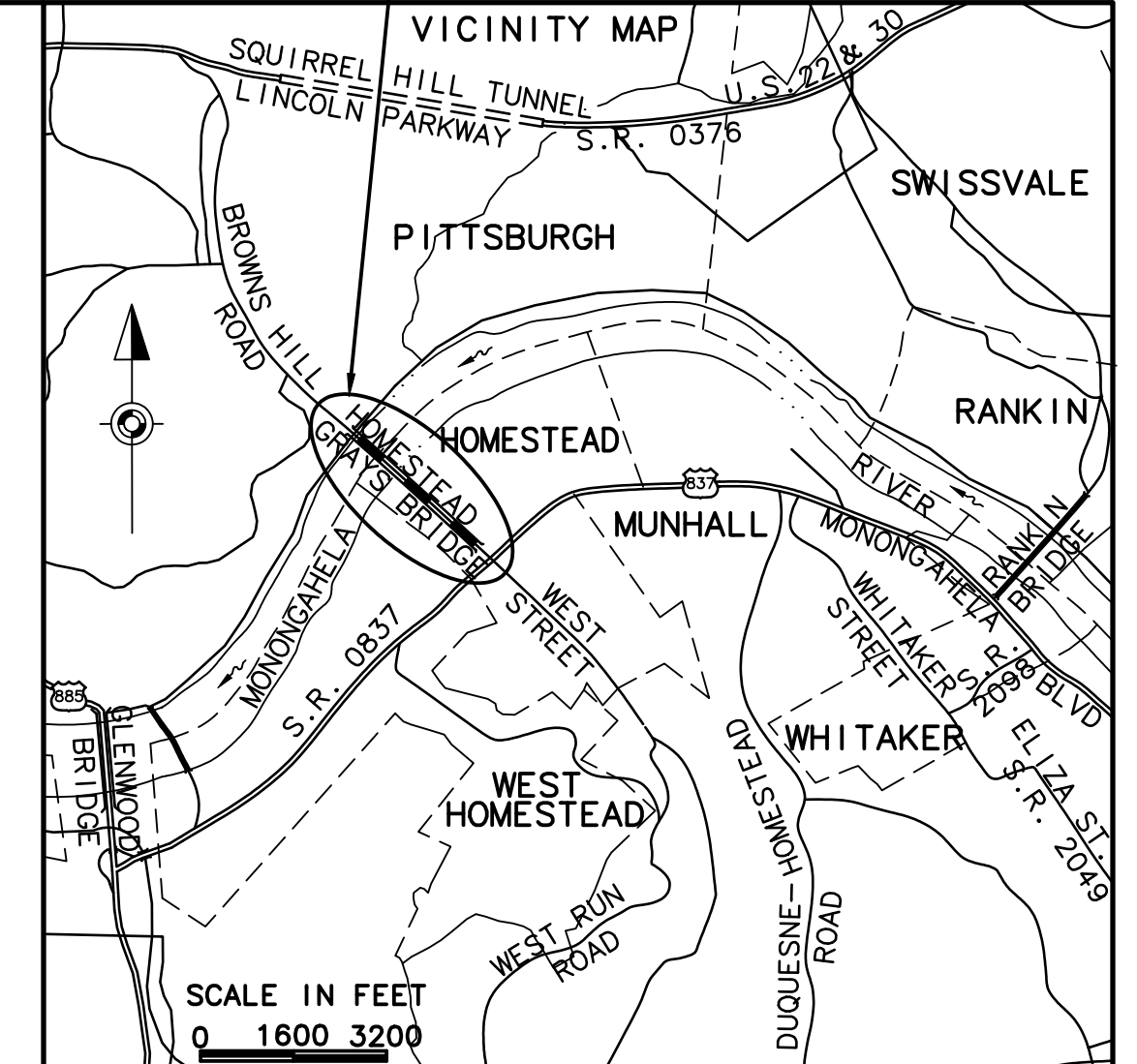
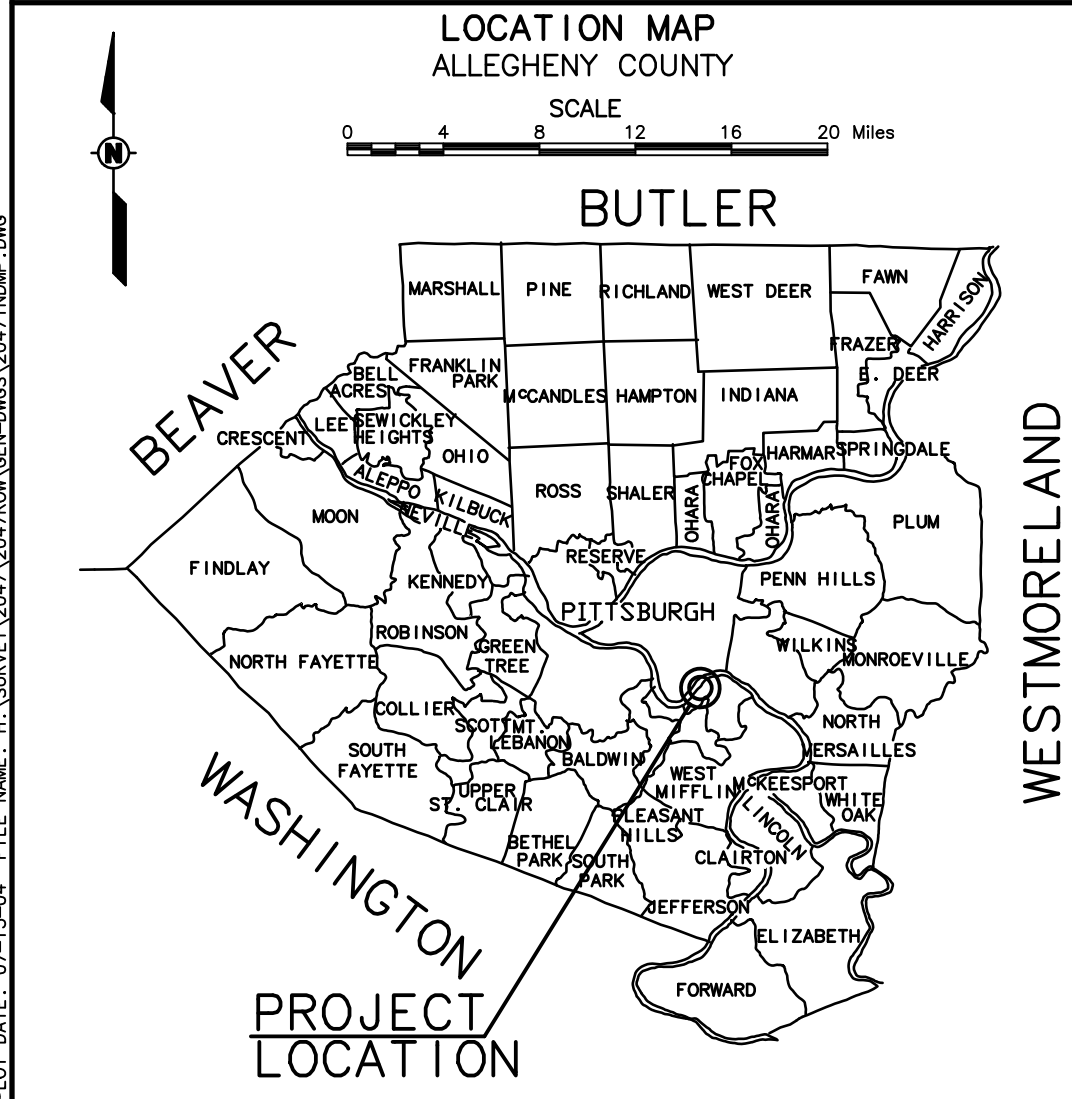
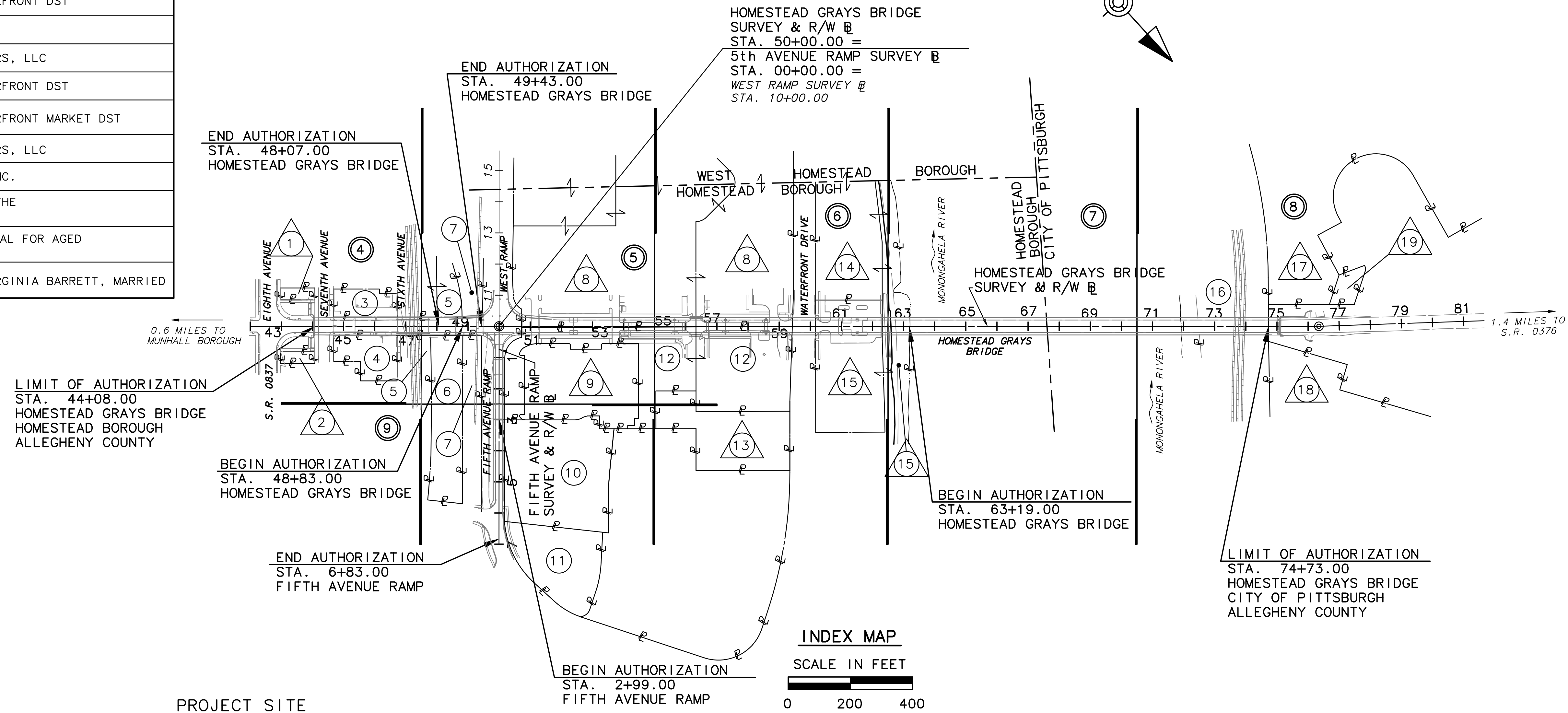

County of Allegheny
Pittsburgh, Pennsylvania
Department of Public Works

REVISIONS			
RIGHT-OF-WAY INDEX MAP HOMESTEAD GRAYS BRIDGE MA12 - 3513			
DRAWN BY: DSH/BPP	CHECKED BY: REP	CADD FILE: 20471NDMP.DWG	25965-RW
DATE: 03-25-04	SCALE: AS SHOWN	SHEET 2 OF 10	